

# AP One AX Lite

Ideal for Those Needing an Enterprise Network Extended



## Integrated Wi-Fi 6 Technology

Manage Centrally With No Additional Hardware Needed

SSID	Security	SSID Visibility	Radio Selection
Production	WPA2 - Personal	✓	2.4 GHz band only
_Guest_2_4G	WPA/WPA2 - Personal	✓	2.4 GHz band only
_Guest_5G	WPA2 - Personal	✓	5 GHz band only
Production_11a	WPA2 - Personal	✓	5 GHz band only
Wireless	WPA2 - Personal	✓	2.4 GHz band only
Wireless_11a	WPA2 - Personal	✓	5 GHz band only
Balance	WPA2 - Personal	✓	2.4 GHz band only
Balance_11a	WPA2 - Personal	✓	5 GHz band only

SSID Management

Day	Download	Upload	Total
2020-07-13	52.90 GB	17.21 GB	70.11 GB
2020-07-12	14.86 GB	0.67 GB	15.54 GB
2020-07-11	15.34 GB	0.67 GB	16.01 GB

Usage Report

Type	Details
system	Time synchronization successful
system	Time synchronization fail
system	Time synchronization successful
system	Time synchronization fail
system	Changes applied
system	Changes applied
system	Changes applied
system	InControl has updated the configuration as tags were updated
system	Wi-Fi Configuration has been updated by InControl
system	InControl has updated the configuration as tags were updated

Searchable Event Log

AP One AX Lite comes equipped with InControl central management. Giving users the ability to control and monitor their network from any web browser. Manage network SSIDs, radio settings, and search event logs with ease to diagnose the entire network.

# Turnkey or Custom Captive Portals

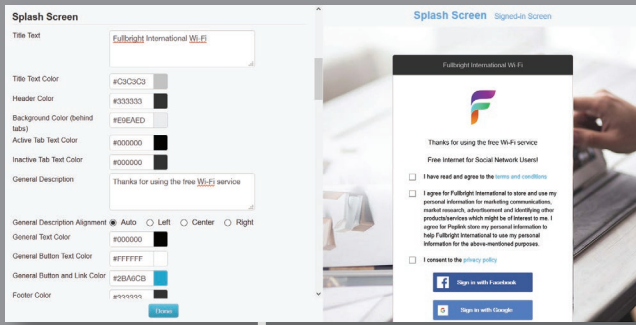

Offer users a more branded experience by customizing captive portals through InControl.

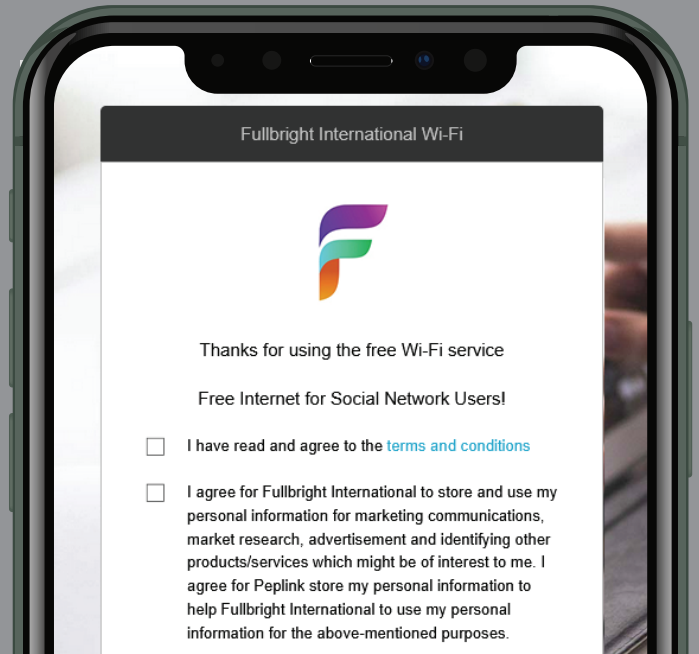
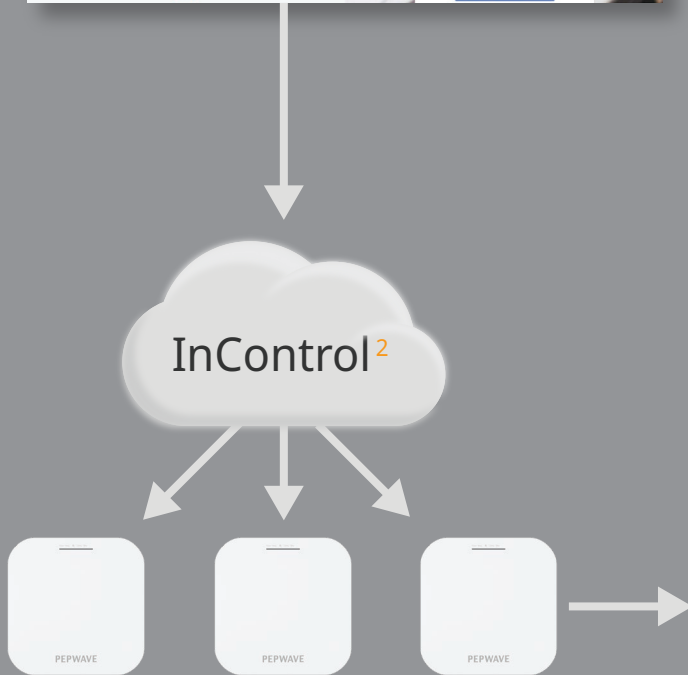

## Wi-Fi Just Got Better

Integrated Wi-Fi 6 is 45% faster than the average Wi-Fi 5, has 4 more device capacity and consumes less power for connected devices.

**Enterprise-Grade Roaming Speeds**  
Supports 802.11k/v/r, providing users a seamless roaming experience between access points.



# Seamless Peplink SD-WAN Integration

Effortlessly integrate Peplink solutions with **AP One AX Lite** to provide unique network capabilities and network flexibility, making the whole experience more user friendly.

## Centrally Managed with InControl

Monitor network health on a single dashboard. Push configuration profiles on multiple devices at once. Remotely access the Web Admin of any device.

## Balance/MAX/FusionHub

Provides unbreakable connectivity by combining multiple WANs. Works with InControl to centralize VLAN, firewall, and outbound policies.

## SD-Switch

Works with InControl to remotely configure and activate PoE ports. Monitor power consumption.

## AP One

Works with InControl to centralize SSIDs, radio settings, and deliver captive portals.

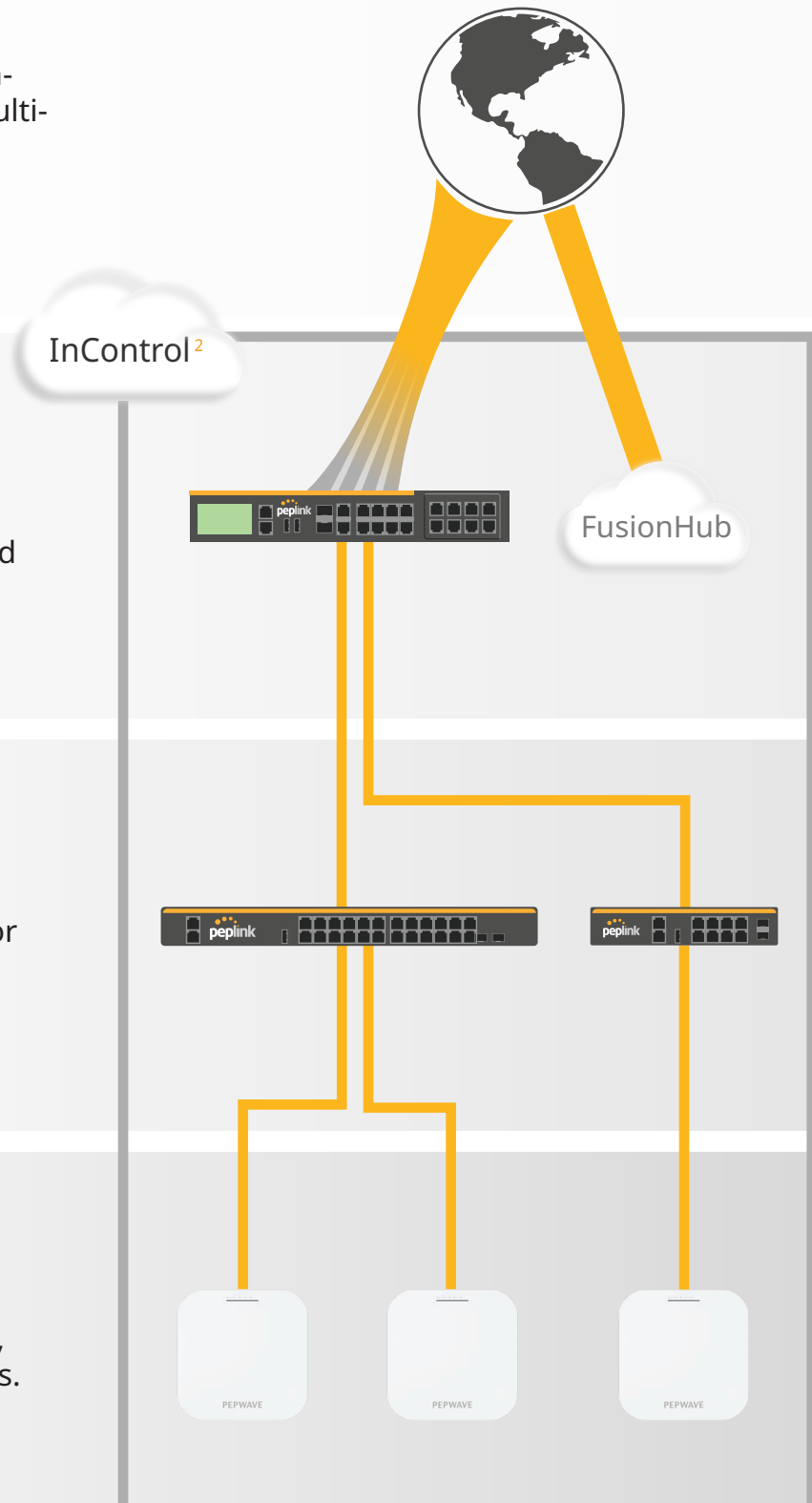

# AP One AX Lite

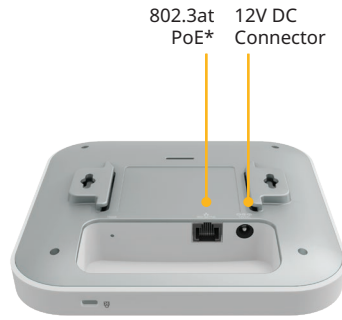

## Specifications

<b>Ethernet Ports</b>	1 x 1 Gbps Gigabit Ethernet	<b>Network</b>	Bridge Mode Router (NAT) Mode Mesh Wireless Distribution System (WDS) Support for PPPoE, Static IP, DHCP Management VLAN Spanning Tree Protocol
<b>Wi-Fi Standard</b>	Simultaneous 1 x 2.4GHz 802.11b/g/n/ax 1 x 5GHz 802.11a/n/ac/ax	<b>Radio</b>	Multiple SSID Auto Channel Selection Transmit Power Adjustment Neighbor AP Detection
<b>Radio Chains/Streams</b>	2 x 2:2	<b>AP Security</b>	Open WPA/WPA2/WPA3-Personal WPA/WPA2-Enterprise
<b>Data Rates</b>	2.4 GHz: up to 574 Mbps 5 GHz: up to 1200 Mbps	<b>Device Management</b>	Web Administrative Interface InControl Cloud Management Peplink AP Controller SNMP v1, v2c and v3
<b>Channel Width</b>	20/40/80 MHz	<b>Client Management</b>	Per SSID VLAN with QoS (802.1p/802.1q) Bandwidth Control MAC Address Filtering Layer 2 Client Isolation Limit on Max. Number of Clients
<b>Recommended clients per Radio</b>	256		Per Client VLAN with RADIUS VLAN with VLAN Pool Bandwidth Control Multicast Filter IGMP Snooping/Multicast Enhancement
<b>SSID Per Radio</b>	16	<b>Captive Portal by InControl</b>	
<b>Transmit Power</b>	2412 – 2472 MHz: 24dBm 5180 – 5825 MHz: 25dBm	<b>Package Contents</b>	AP One AX Lite, Ceiling Mount Base (9/16" T-Rail), Ceiling Mount Base (15/16" T-Rail), Mounting Screw Set
<b>Antenna</b>	Built-in Omni antenna: 2 x 3dBi - 2.4GHz 2 x 3dBi - 5GHz		
<b>Enclosure</b>	Plenum-rated enclosure		
<b>Dimensions</b>	5.9 x 5.9 x 1.3 inches 160 x 160 x 33 mm		
<b>Weight</b>	0.84 pounds / 382 grams		
<b>Power Input</b>	12V DC Jack (Plug 5.5 x 2.1 mm, center positive)* 802.3af PoE*		
<b>Power Consumption</b>	14.5W (max.)		
<b>Operating Temperature</b>	32°F - 104°F 0°C - 40°C		
<b>Certifications</b>	FCC, CE, RoHS		
<b>Warranty</b>	1 Year Limited Warranty		

\* AC/DC adapter and PoE Injector are not included.

## Ordering information

Product Code	Description
APO-AX-LITE	2 x 2 MU-MIMO Wi-Fi 6 AP for business, manageable by InControl. Simultaneous Dual-Band 802.11ax/ac/b/g/n

## Feature Add-on

Product Code	Description
ACW-107	802.3af/at PoE Injector. Compatible with MAX Hotspot and AP One AX Series
ACW-602	1x12V3A Power Supply. Compatible with MAX HD2 and AP One AX Series